

Note - this survey done tolerably well, but there was an error in the Protraction of it. F.I.

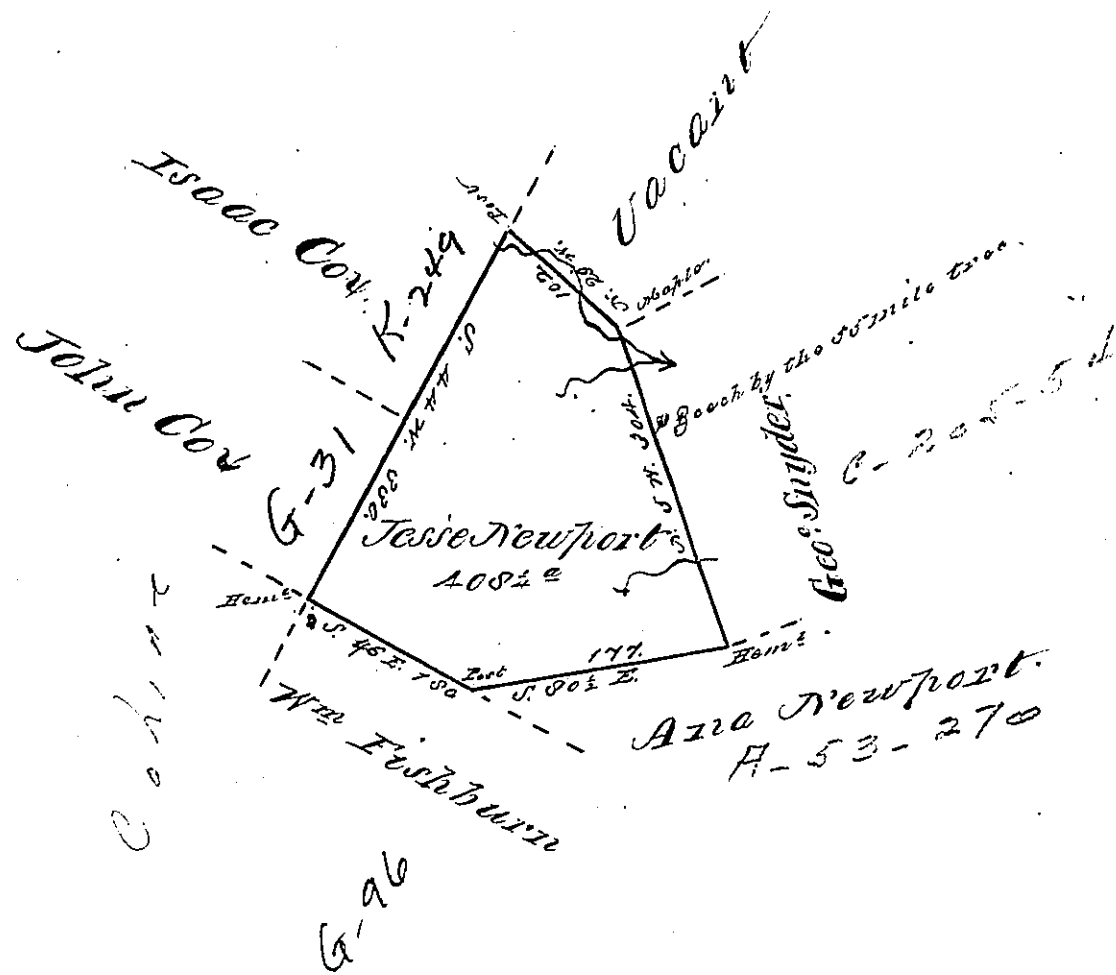

A draft of a tract of Land called Situate adjoining land  
 Surveyd for Ann Newport & others in the County of Luzerne,  
 Containing Four hundred Eight & 1/4 acres & allow. of 2 in per.  
 cent for roads &c. Surveyed for Jesse Newport the 20<sup>th</sup> day  
 of Novem<sup>r</sup>. 1791. in pursuance of a warrant bearing date the  
 10<sup>th</sup> day of Novem<sup>r</sup>. 1791.  
 Saul Brodhead Esq<sup>r</sup>.  
 Surveyor General }  
 by Wm Gray D.D.

The True  
 Protraction  
 F.I.

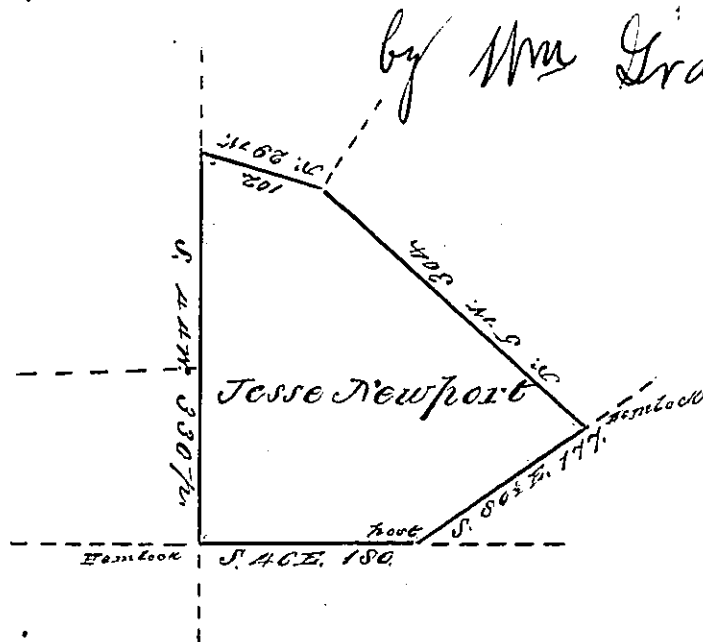

IN TESTIMONY that the above is a copy of the original remaining on file in the Department of Internal Affairs of Pennsylvania, made conformably to an Act of Assembly approved the 16th day of February, 1833, I have hereunto set my Hand and caused the Seal of said Department to be affixed at Harrisburg, this

Second day of March 1877

*Wm. Handley*  
 Secretary of Internal Affairs